

LA BUVETTE®

Rue Maurice Perin - Z. I. de Tournes
F-08013 CHARLEVILLE-MEZIERES Cedex FRANCE
TEL : 03.24.52.37.20 - FAX : 03.24.52.37.24
Int. : +33.3.24.52.37.23 Int. : +33.3.24.52.37.24
S.A.V. : 03.24.52.37.27 - FAX : 03.24.52.37.19
Internet : www.labuvette.com
e-mail : commercial@labuvette.com
sav@labuvette.com

LOGISTAR

Ref : D111 - Ivoire - -
D113 - Blanche - -

MINISTAR

Ref : D112 - Ivoire - -
D114 - Blanche - -

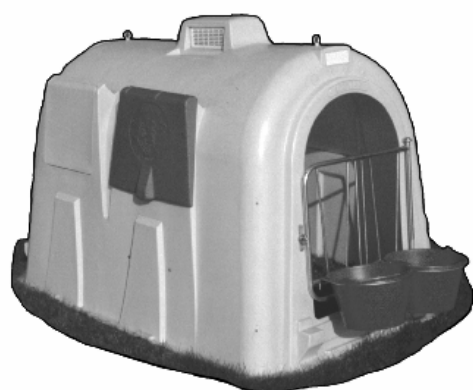
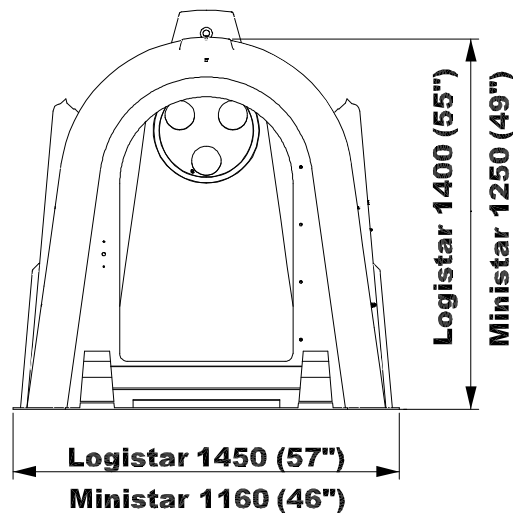
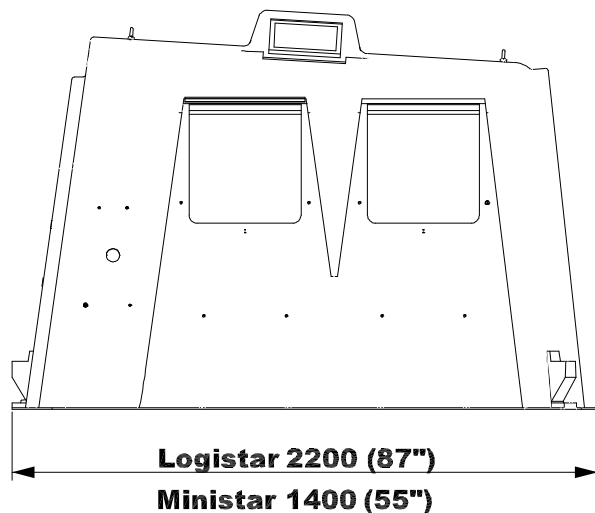
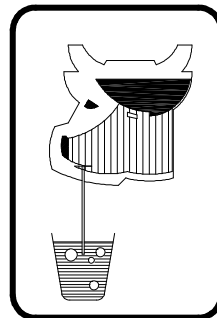

(D)

(F) Pour un veau jusqu'au sevrage : 2 Porte-seaux "D128" ou D129 + 1 Portillon "D125" + 1 Ratelier "D123" + 1 Capot "D122"

(GB)



(D)

(F) Logistar pour 2 veaux jusqu'a 1 mois : Equipe du portillon D134 avec 1 porte-seaux (D128 ou D129) et 2 seaux a tétine D126

(GB)

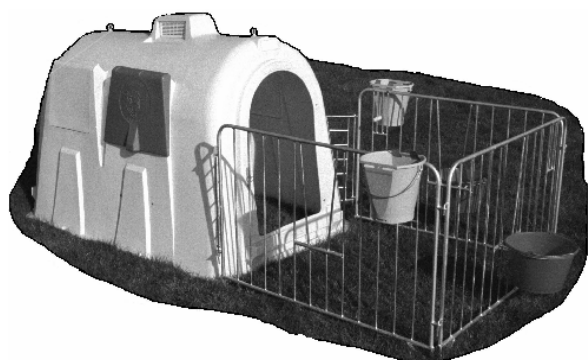

(D)

(F) Pour un ou deux veaux jusqu'au sevrage : 1 Porte-seaux "D128 ou D129 + 2 seaux à tétines "D126" + 1 Enclos "D127" + 1 Ratelier "D123" + 1 Capot "D122"

(GB)

D 122

x1

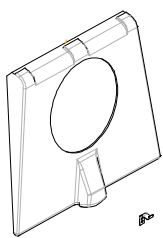

x6

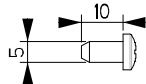

D 123

x1



x4

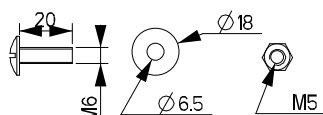

D 125 - D 134

x1

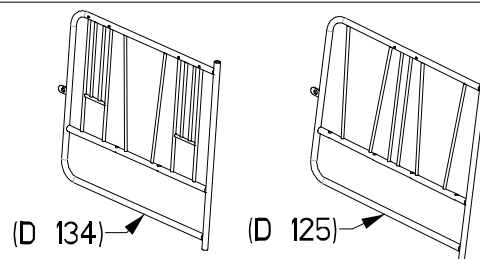

x2

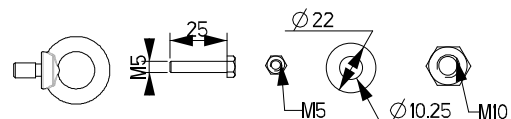

D 129

x1

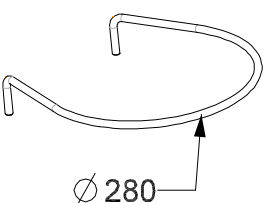

D 128

x1

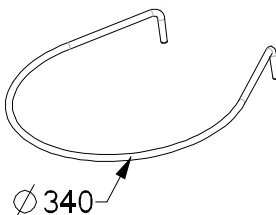

D 127

x3

x1

x2

x4

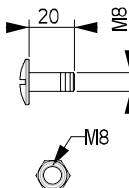
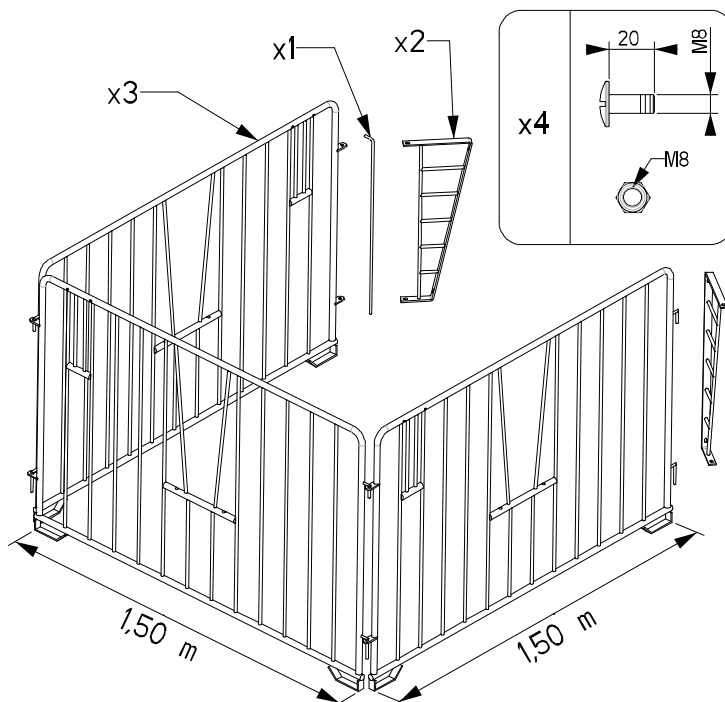

D 126

x1

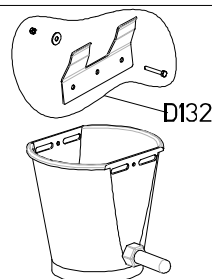

D 130

x1

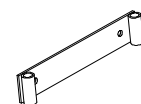

x2

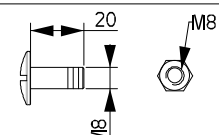

D 132

x1

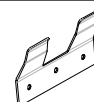

x2

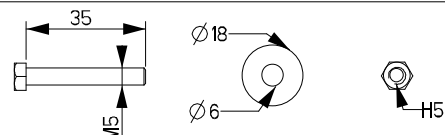

(D)

(F)

(GB)

Après nettoyage, remettre la niche en position verticale

